

HENRY AIRTOOLS

American Made Industrial Tools

MODELS

400GHSRD

400GHKSRD

General Safety and Maintenance Manual

REAR EXHAUST



REAR EXHAUST



REAR EXHAUST

"REAR EXHAUST" Horizontal Collet Type Die Grinder (1.2 H.P.)

Model Number	Exhaust Direction	Throttle Type	Speed	Power Output	Weight		Overall Length	Housing Diameter	Working Air Consumption	Spindle Thread & Length/ Output
					Alum. CASE	STEEL CASE				
4400GHSRD;18000;1/4"	REAR	(L) Lever or (K) Safety Lever	18000RPM or 20000	1.2 H.P. (900 W)		3.8 Lbs. (1.7 Kg)	12.5 Inch (318 mm)	1.6 Inch (41 mm)	25 cfm (11.8 L/S)	ER COLLET
400GHKSRD;18000;1/4										ER COLLET

THE HENRY TOOL CO., MANUFACTURED BY HENRY TOOLS

498 SO. BELVOIR BLVD., SOUTH EUCLID, OH 44121 U.S.A.

PH: (216) 291-1011 OR (800) 826-5257 • FAX: (216) 291-5949 OR (800) 303-2800

EMAIL: DAVIIDH@MSN.COM • WEBSITE: WWW.HENRYTOOLS.COM



Model 400GHKSRD REAR EXHAUST GRINDER with (1.2 H.P.) motor. (REAR EXHAUST COLLET MODEL)

REAR EXHAUST MODEL

MODELS
400GHSRD
400GHKSRD

SIDE EXHAUST CASE

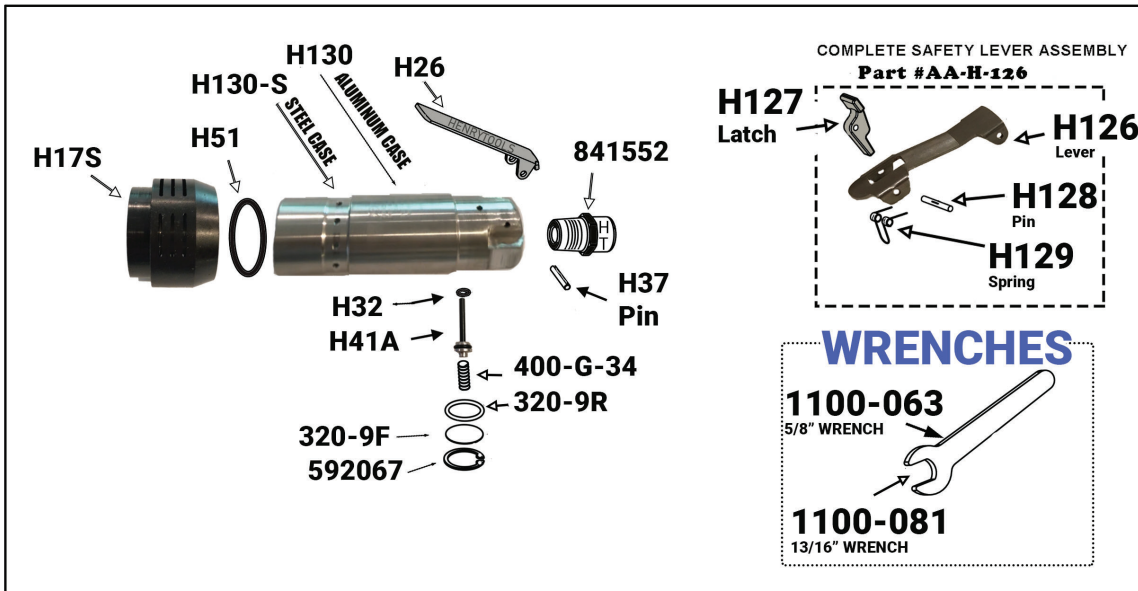

REAR EXHAUST CASE

REAR EXHAUST MODEL

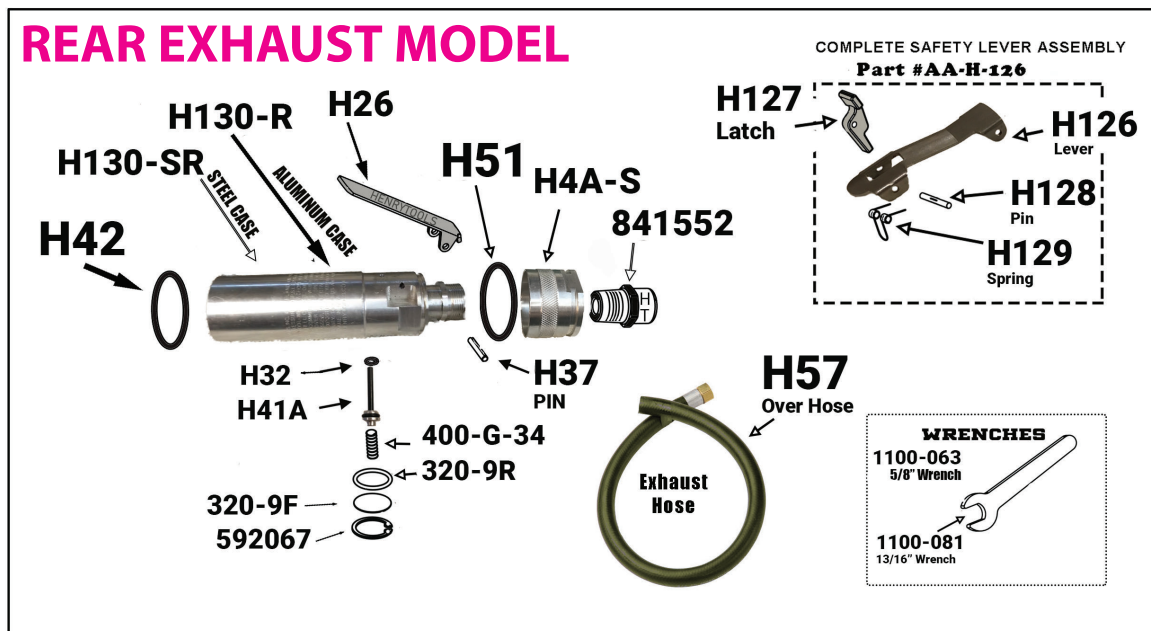



Model 400GHKSRD REAR EXHAUST GRINDER with (1.2 H.P.) motor. (REAR EXHAUST COLLET MODEL)

REAR EXHAUST MODEL

MODELS
400GHSRD
400GHKSRD

FRONT END EXTENSION ASSEMBLY

REAR EXHAUST MODEL

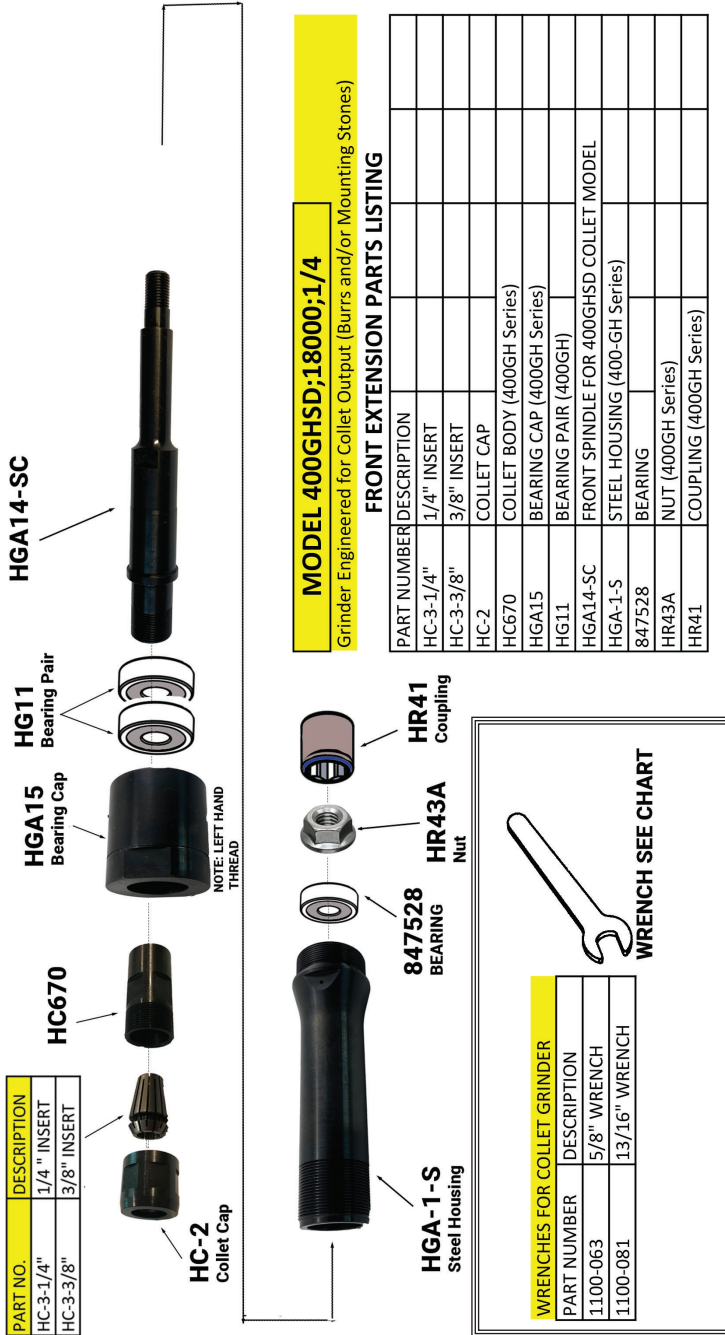

MODEL 400GHSD; 18000; 1/4
Grinder Engineered for Collet Output (Burrs and/or Mounting Stones)

FRONT EXTENSION PARTS LISTING

PART NUMBER	DESCRIPTION
HC-3-1/4"	1/4" INSERT
HC-3-3/8"	3/8" INSERT
HC-2	COLLET CAP
HC670	COLLET BODY (400GH Series)
HGA15	BEARING CAP (400GH Series)
HG11	BEARING PAIR (400GH)
HGA14-SC	FRONT SPINDLE FOR 400GHSD COLLET MODEL
HGA-1-S	STEEL HOUSING (400-GH Series)
847528	BEARING
HR43A	NUT (400GH Series)
HR41	COUPLING (400GH Series)

WRENCHES FOR COLLET GRINDER

PART NUMBER	DESCRIPTION
1100-063	5/8" WRENCH
1100-081	13/16" WRENCH

WRENCH SEE CHART

FRONT END EXTENSION ASSEMBLY

REAR EXHAUST MODEL



Model 400GHKSRD **REAR EXHAUST GRINDER** with (1.2 H.P.) motor. (**REAR EXHAUST COLLET MODEL**)

MODELS
400GHSRD
400GHKSRD

REAR EXHAUST MODEL

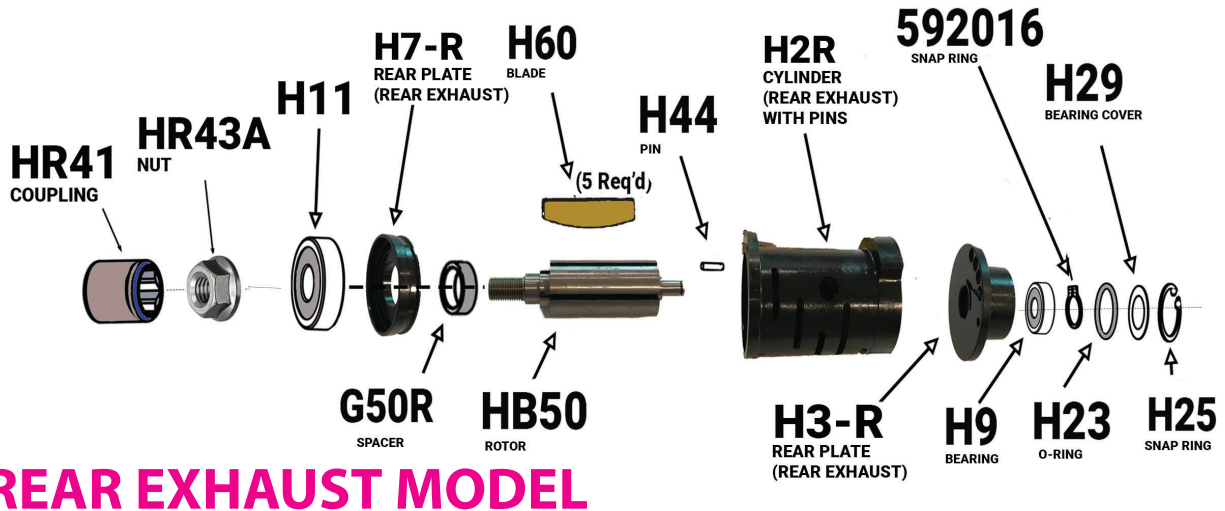

REAR EXHAUST MODEL

PART NUMBER	DESCRIPTION	PART NUMBER	DESCRIPTION
592016	SNAP RING	H-130	ALUM.CASE(SideEXHAUST)(400GH)
592067	SNAP RING (400GH)	H130-R	REAR EXHAUST CASE ALUMINUM (400GH)
841552	SCREEN BUSING	H130-S	STEEL CASE (SIDE EXHAUST) (400GH)
100-081	13/16" WRENCH	H130-SR	REAR EXHAUST CASE STEEL (400GH)
1100-063	5/8" WRENCH	H-17S	EXHAUST SLEEVE (400GH)
320-9F	VALVE COVER (400-GH)	H2R	CYLINDER (REAR EXHAUST)(400GH Series)
320-9R	O-RING	H23	O-RING (400GH)
400-G-34	SPRING	H25	SNAP RING (400GH)
AA-H126	SAFETY LEVER ASSEMBLY COMPLETE (400GH)	H26	STANDARD LEVER (400GH)
G50R	SPACER (400GH)	H29	BEARING COVER (400GH)
H11	BEARING	H32	O-RING (400GH)
H126	LEVER (400GH)	H37	PIN (400GH)
H127	LATCH (400GH)	H3-R	REAR END PLATE (400GH)(REAR EXHAUST)
H128	PIN (400GH)		
H129	SPRING (400GH)		



Model 400GHKSRD REAR EXHAUST GRINDER with (1.2 H.P.) motor. (REAR EXHAUST COLLET MODEL)

MODELS
400GHSRD
400GHKSRD

REAR EXHAUST MODEL

PART NUMBER	DESCRIPTION
H41A	THROTTLE VALVE (400GH)
H42	O-RING (400GH)
H44	PIN (400GH)
H4A-S	REAR EXHAUST SLEEVE DIFFUSER (400GH)
H51	O-RING (400GH)
H57	EXHAUST HOSE (400GH)
H60	ROTOR BLADE (400GH) (5 are Req'd)
H7-R	FRONT ENDPLATE (REAR EXHAUST) (400GH)
H9	REAR BEARING (400GH)
HB50	ROTOR (400GH Series)
HC-2	COLLET CAP (400GH)
HC-3-1/4"	1/4" INSERT (400GH)
HC-3-3/8"	3/8" INSERT (400GH)
HC670	COLLET BODY (400GH)
HG11	BEARING PAIR (400GH)
HGA14-SC	FRONT SPINDLE FOR 400GHSD COLLET MODEL
HGA15	BEARING CAP (400GH)
HGA-1-S	STEEL FRONT EXT. HOUSING (400GH)
HR41	COUPLING (400GH)
HR43A	NUT (400GH)

REAR EXHAUST MODEL

510286 REPAIR KIT

Includes the following:

QTY	PART NO.	DESCRIPTION
1	H11	FRONT BEARING
5	H60	ROTOR BLADE
1	H9	REAR BEARING
1	H23	O-RING
1	592016	SNAP RING
1	H24	BEARING COVER
1	H25	SNAP RING
1	H32	O-RING
1	592044	SNAP RING
1	847528	BEARING
1	HG11	BEARING PAIR

REAR EXHAUST MODEL

REAR EXHAUST MODEL

HENRY TOOLS, INC. Ph: (216) 291-1011 or (800) 826-5257