

HENRY TOOLS

Industrial Airtools at Work

MODEL
4126GL
Series



General Safety and Maintenance Manual

Pre-Year 2009 Old Style Model

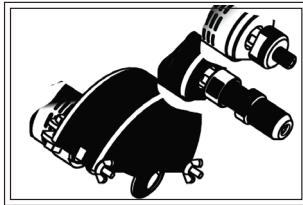

OLD STYLE

Pre-Year 2009 Old Style Model

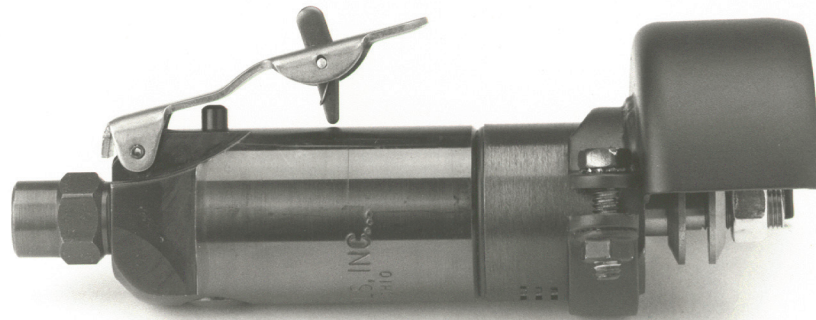

Model Number	Exhaust Direction	Throttle Type	Speed	Power Output	Case Material	Weight		Length	Diameter	Air Consumption	Spindle Type
						Aluminum	Steel				
4126GL	Side	(L) Lever	15000 to 22000 R.P.M. (18000RPM is Standard)	0.9 H.P. 675 W	Steel or Aluminum	1.6 lb/0.7 Kg	2.0 lb/0.9 Kg	5 1/2" 140mm	1.6 inches 41 mm	25cfm 11.8 L/S	3/8-24 threaded spindle
4126GLS		(K) Safety Lever									

THE HENRY TOOL CO., MANUFACTURED BY HENRY TOOLS

498 So. Belvoir Blvd., South Euclid, OH 44121 U.S.A.

Ph: (216) 291-1011 or (800) 826-5257 • Fax: (216) 291-5949 or (800) 303-2800

Email: daviidh@msn.com • Website: www.Henrytools.com

MODEL
4126GL
Series

Pre-Year 2009 Old Style Model

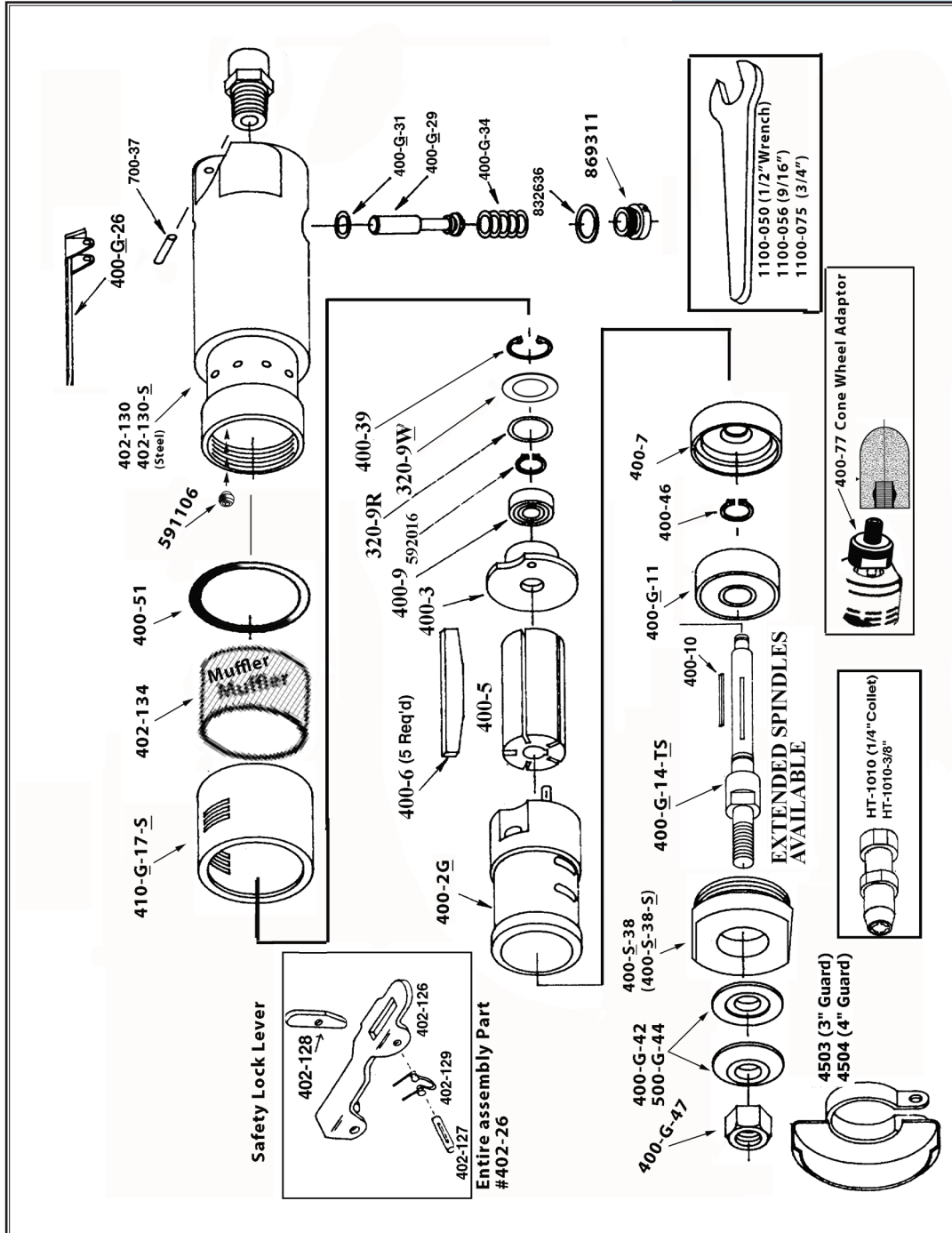
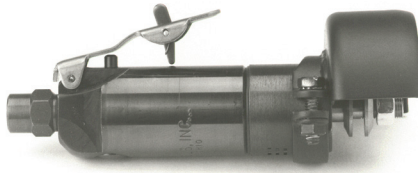

THE HENRY TOOL CO. MANUFACTURED BY HENRY TOOLS

498 So. Belvoir Blvd., South Euclid, OH 44121 U.S.A.
Ph: (216) 291-1011 or (800) 826-5257 • Fax: (216) 291-5949 or (800) 393-2800
Email: davidhdh@msn.com • Website: www.Henrytools.com

General Operators Instructions and Service Manual

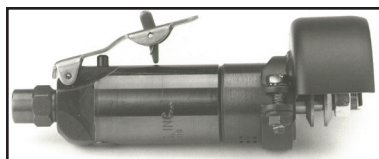

MODEL
4126GL
Series

Pre-Year 2009 Old Style Model

PART	DESCRIPTION
320-9R	O-RING
320-9W	BEARING COVER
400-G-11	FRONT BEARING
400-G-14-TS	COLLET SPINDLE
400-G 14-TS+3	3" EXTENDED SPINDLE
400-G 14-TS+6	6" EXTENDED SPINDLE
400-G-26	THROTTLE LEVER
400-G-29	THROTTLE VALVE-INCLUDES 844302
400-G-34	SPRING
400-2G	CYLINDER
400-2GR	REVERSE ROTATION CYLINDER
400-10	KEY
400-3	REAR ENDPLATE
400-39	O-RING
400-3R	REVERSE ROTATION REAR ENDPLATE(Special)
400-44	ROLL PIN
400-46	SNAP RING
400-5	ROTOR
400-51	O-RING
400-6	BLADE (5 REQ)
400-7	FRONT ENDPLATE
400-9	REAR BEARING
402-126	SAFETY LEVER
402-127	SAFETY LEVER PIN
402-128	LOCKOUT LEVER
402-129	SAFETY LEVER SPRING
402-130	ALUMINUM CASE (SPECIFY SPEED)
402-130-S	STEEL CASE (SPECIFY SPEED)
402-134	MUFFLER SCREEN
410-G-17-S	STEEL SIDE EXHAUST SLEEVE
540129	STEEL MOTOR RETAINER
700-37	THROTTLE LEVER PIN
591106	SET SCREW (SPECIFY SPEED)
592016	SNAP RING
832636	GASKET
841553	3/8 NPT TO 1/4 NPT BUSHING
844302	O-RING
869311	THROTTLE VALVE CAP
WRENCHES	
1100-044	7/16" WRENCH
1100-063	5/8" Wrench
ASSEMBLIES	
510075	REPAIR KIT
402-26	SAFETY LEVER ASSY.
AA-402-132	ALUMINUM CASE ASSY.

PART	DESCRIPTION
AA-402-132-S	STEEL CASE ASSY.
AA-402-132-SK	STEEL SAFETY CASE ASSY. SPECIFY SPEED FOR CASE ASSY.
209	3/8-24 ERICKSON 3 PIECE-WITH-1/4" INSERT
ACCESSORIES	
400-77	3/8-24 THREADED 9/16 SPACER (CONE WHEEL ADAPTOR)
HT-1010	3/8-24 TO 1/4" I.D.- 2 PIECE HEAVY DUTY
HT-1010-3/8"	3/8-24 TO 1/4" I.D.- 2 PIECE HEAVY DUTY
209-B	3/8-24 COLLET BODY (ERICKSON)
209-1	COLLET NUT (ERICKSON)
209-1/8	1/8" INSERT (ERICKSON)
209-3/16"	3/16" INSERT (ERICKSON)
209-1/4	1/4" INSERT (ERICKSON)
209-5/16	5/16" INSERT (ERICKSON)
209-3/8	3/8" INSERT (ERICKSON)
400-78	3/8-24 TO 5/8-11 ADAPTER
400-76J	9/16 UNTHREADED SPACER
400-76J-3/8	3/8 UNTHREADED SPACER
ERICKSON COLLET ASSEMBLIES	
AA-209-1/8	3/8-24 ERICKSON 3 PIECE-WITH-1/8" INSERT
AA-209-3/16	3/8-24 ERICKSON 3 PIECE--WITH 3/16" INSERT
AA-209-1/4	3/8-24 ERICKSON 3 PIECE-WITH-1/4" INSERT
AA-209-5/16	3/8-24 ERICKSON 3 PIECE--WITH 5/16" INSERT
AA-209-3/8	3/8-24 ERICKSON 3 PIECE--WITH 3/8" INSERT

THE HENRY TOOL CO., MANUFACTURED BY HENRY TOOLS

498 So. Belvoir Blvd., South Euclid, OH 44121 U.S.A.
Ph: (216) 291-1011 or (800) 826-3457 • Fax: (216) 291-5949 or (800) 303-2800
Email: davidhdh@msn.com • Website: www.Henrytools.com

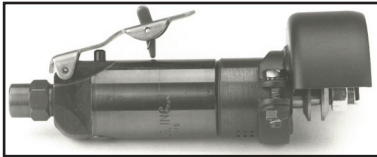

MODEL
4126GL
Series

**SAMPLE : MOUNTING OF CONE WHEELS
ON HORIZONTAL GRINDERS**



**SAMPLE : MOUNTING OF CARBIDE BURRS ON
HORIZONTAL GRINDERS**

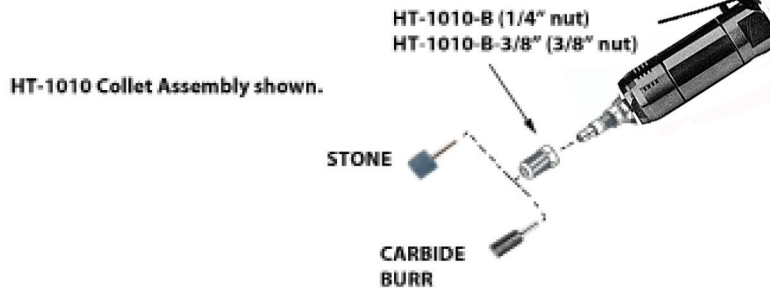

Erickson Collet Assembly shown.

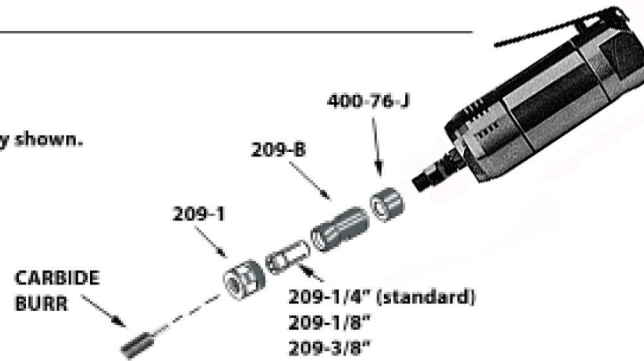

**Sample: Horizontal Grinder with Guard for mounting
Type 1 grinding wheels.**



THE HENRY TOOL CO. MANUFACTURED BY HENRY TOOLS
498 So. Belvoir Blvd., South Euclid, OH 44121 U.S.A.
Ph: (216) 291-1011 or (800) 826-5257 • Fax: (216) 291-5949 or (800) 363-2800
Email: davidhdh@msm.com • Website: www.Henrytools.com